

# Dimensions

size(mm)

## ■ CLESTA eIII -EURUS LIGHT-

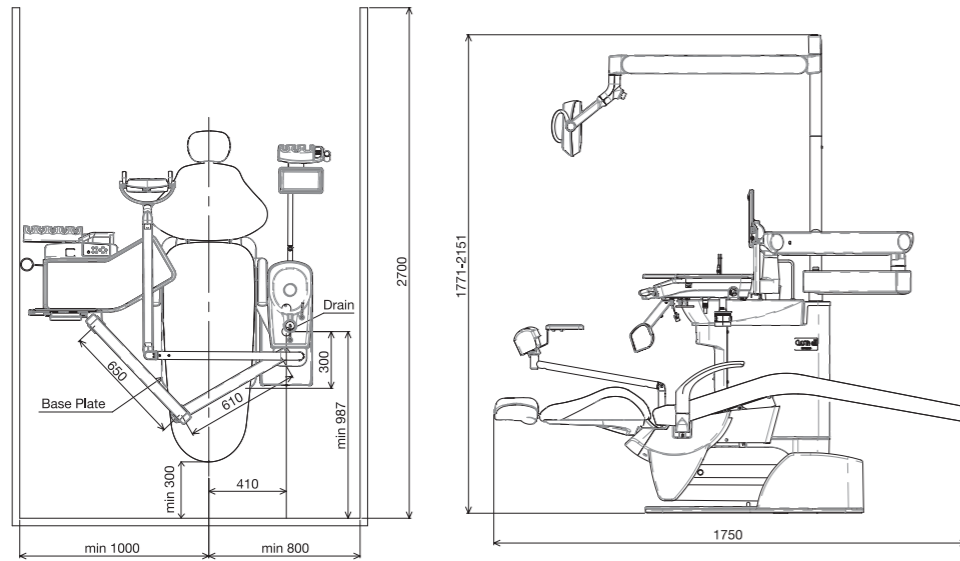

## ■ CLESTA eIII -300 LED LIGHT-

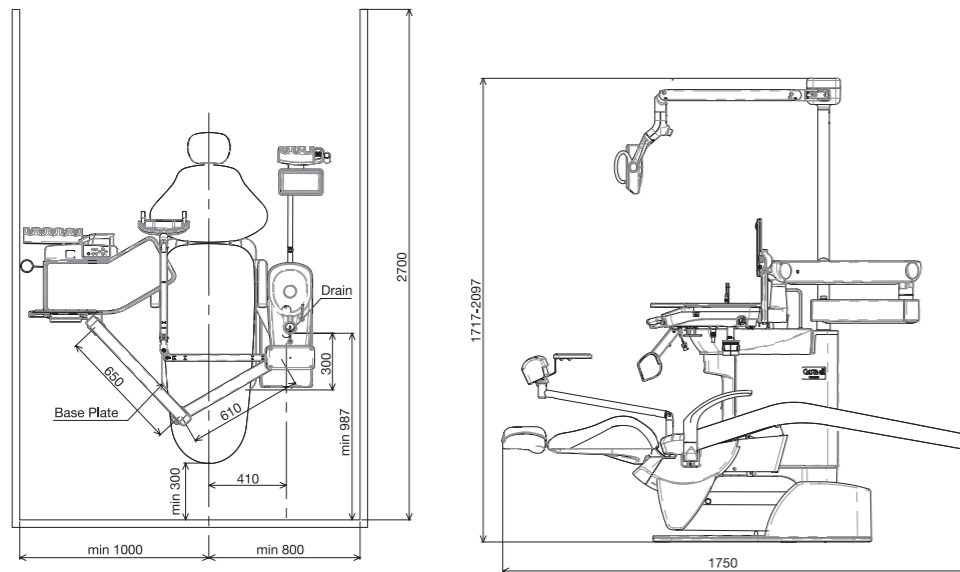

# CLESTA eIII



Names of Components  
 Dental Unit : CLESTA eIII  
 Dental Chair : CLESTA eIII CHAIR  
 CLESTA eIII PEDO CHAIR  
 Dental Light : EURUS LIGHT  
 300LED DENTAL LIGHT TYPE 301

# CLESTA eIII

offers dentists and patients the comfort of smooth dental treatment

## Ergonomics

- Smooth tilting movement by hydraulic system
- Ergonomically shaped cushions

## Ease

- Smooth-moving operator's table
- Easy-access handpiece holders
- Minimize stress during use

## Efficiency

- Create the ideal dentistry environment for both dentists and patients



## Variations

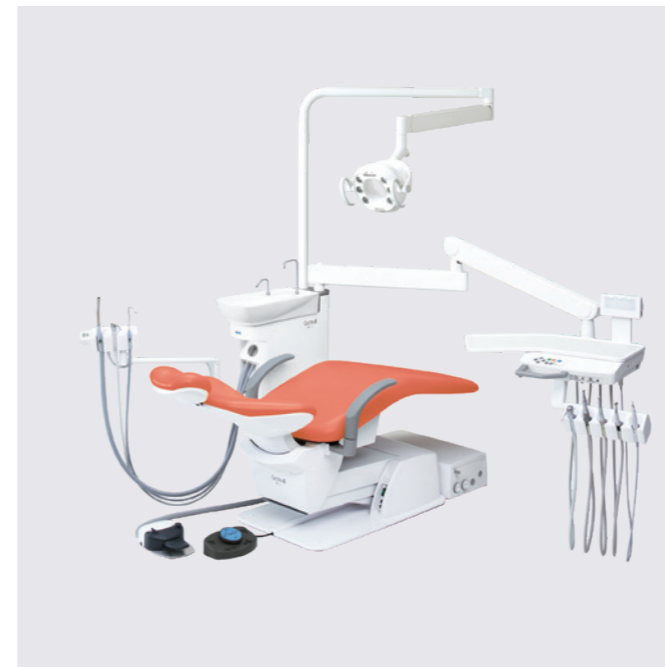

Holder type



Rod type

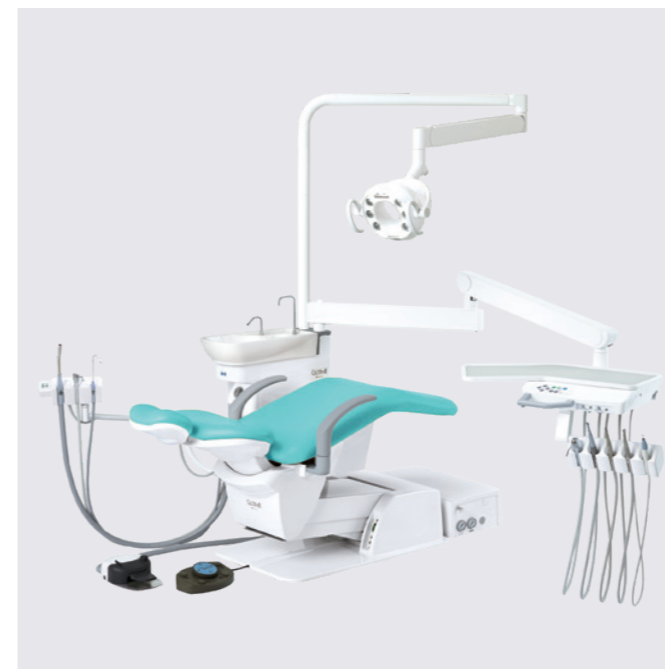

Holder type (Pedodontic chair)



Cart Holder type

The combination of electro-hydraulic and air operated system ensures a high standard of reliability and safety.



## Unit & Chair

### Cuspidor

Easy-to-clean porcelain cuspidor bowl is shaped to prevent rinsing water from spilling out.

### Chair

- Powerful hydraulic system enables a wide range of lift heights.
- Ergonomically designed chair cushion ensures patient comfort. The reclining backrest is designed to prevent the patient from sliding.

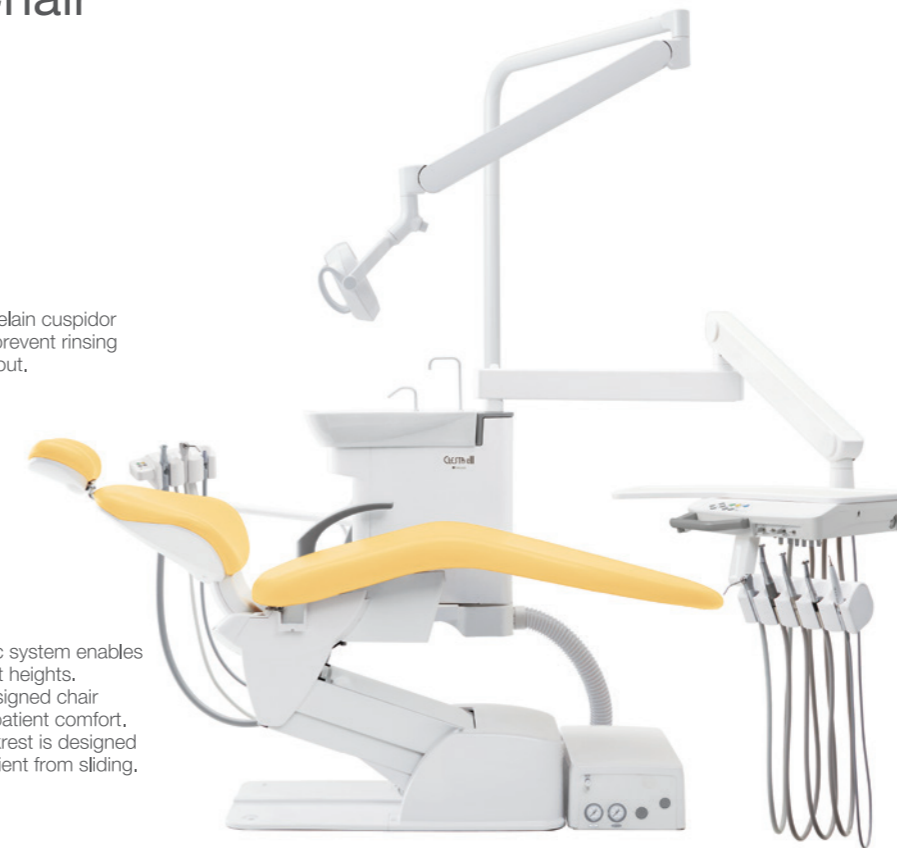

### Balance arm

Employing an air brake system, the balance arm enhances mobility and flexibility during dental practice.

### Operator's table

Large operator's table ensures ease of use. Swiveling handpiece holder for most appropriate position for dentist.

## Light



### EURUS LIGHT

The EURUS LIGHT provides sensor activation, stepless intensity between 3,000 lx and 28,000 lx, reproduces natural light with a high functional color rendering capacity.

### Flexible lighting

The Belmont spring arm allows the light to be moved around and stay exactly where it is desired so that the dentist/dental assistant can start treatment smoothly. The arm covers a wide area, including the maxillary and mandibular areas of the patient, for sufficient illumination.



### 300 LED LIGHT

The 300 LED light provides sensor activation, stepless intensity between 3100 lx and 28000 lx, three axis rotation and clear light pattern.

## Options & Accessories



### Flushing tray

The flushing system enables easy cleaning of handpiece water lines. The flushing tray as an extra option allows hands-free flushing.

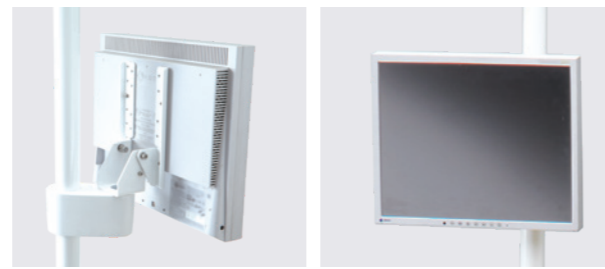

### Monitor bracket

The flat screen monitor bracket can be adjusted to suit individual need. (not including monitor)



### Clean water system

The clean water system offers a choice of 750-ml or 2-liter bottles and can be integrated into the unit to supply handpiece water. The aesthetic cover is an extra option.



### Foot control

One foot control can be selected between two switches to regulate chair movement: ① a manual control switch for up, down, forward, and backward movement, and ② a programmed-position control switch for 0, 1, 2 and last position. Foot control handle is available as an option.



### Assistant's console

Assistant sub-tray increases assistant's work efficiency. (Metal sub-tray is not included.) Moreover, curing light holder enhances the operability of the curing light. HVE tips and SE tip are optional.

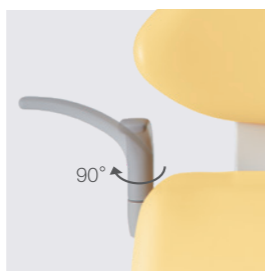

### Rotating armrest

A swing-out armrest for the right side makes it easy for patients to hold and helps elderly patients mount and dismount the chair with ease.



### Double articulating headrest

Suitable for children and adults, and it's improved to adjust patient positioning easily.

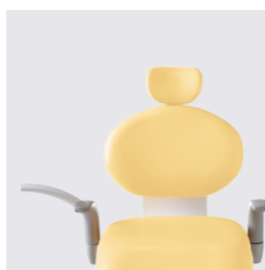

### Pedodontic chair





















CLESTA eIII PEDO has a smaller backrest, a shorter seat and a lower cuspidor position to accommodate young children. The double articulating headrest is available as an option.

● Standard | ○ Selectable | - Not available

	Standard	PEDO chair
<b>Chair</b>		
Articulating headrest	●	●
Double articulating headrest	○	○
Armrest at left side only (fixed)	●	-
Armrest at both side, left side fixed & right side rotated	○	●
8-way foot switch (manual/auto)	●	●
<b>Dentist Element</b>		
Membrane switch (chair auto/manual, cupfiller)	●	
Large operator's table with silicon mat	●	
Small size operator's table with silicon mat	○	
Foot controller A3	●	
Combined foot controller	○	
3-way syringe	●	
Midwest 4-way turbine hose	○	
Electric micromotor	○	
Electric scaler	○	
<b>Unit Body</b>		
Air timered cupfiller & bowl flush		●
Sensored cupfiller & bowl flush		○
Water heater		○
Clean water system		○
Separator		○
Flushing tray		○
Monitor bracket		○
Separated junction box		●
Water Service Outlet		○
Air Service Outlet		○
<b>Assistant Element</b>		
Standard type assistant arm	●	
3-way syringe	●	
<b>Light</b>		
EURUS LIGHT		○
300 LED LIGHT		○

## Upholstery Color Options

The colors come in four themes: warm, cool, earth and vitamin. Any choices from these leather colors should match the interior appointments of your clinic.

<b>Warm Color</b>						
	Coral Pink/ES20	Light Pink/ES30	Beige/ES21	Camel/ES14	Bordeaux/ES12	Black/ES8
<b>Cool Color</b>						
	Mint Blue/ES5	Indigo Blue/ES25	Light Blue/ES16	Purple/ES26	Light Gray/ES33	Gray Teal/ES28
<b>Earth Color</b>						
	Rose/ES34	Mauve/ES27	Forest/ES31	Aldo Blue/ES23	Ash Gray/ES32	Chocolate/ES11
<b>Vitamin Color</b>						
	Scarlet Red/ES24	Mandarin Orange/ES22	Lemon Yellow/ES2	Yellow Green/ES18	Sky Blue/ES7	Blue/ES29